

FLORENCE MALL

2028 Florence Mall, Florence KY 41042

PROPERTY

Demographics	1 mile	3 miles	5 miles
Population	8,274	65,413	140,042
Avg. HH Income	\$106,872	\$98,979	\$107,592
Total Households	3,338	26,295	53,685

HIGHLIGHTS

- Strategically situated within an active retail corridor adjacent to the intersection of Burlington Pike and I-75/71, with excellent access and visibility from these thoroughfares
- 5 miles South of Cincinnati Int'l Airport
- 15 minutes outside of Cincinnati, OH
- Core National Tenants such as Kroger, Ross, TJ Maxx, Costco, Burlington, Hobby Lobby, and more located across the street

NOTES

- GLA: 963,727 SF
- Availabilities: Inline, Anchor, Outparcel
- Traffic Count: I-71 117,140 VPD
Burlington Pike 54,360 VPD

NOTABLE TENANTS

- JC Penney, Macy's & Cinemark



MASON
ASSET MANAGEMENT

T: 516 371.5858
E: leasing@masonam.com
150 Great Neck Road Suite 402
Great Neck, NY, 11021
www.masonam.com

FLORENCE MALL

2028 Florence Mall, Florence KY 41042

SITE PLAN

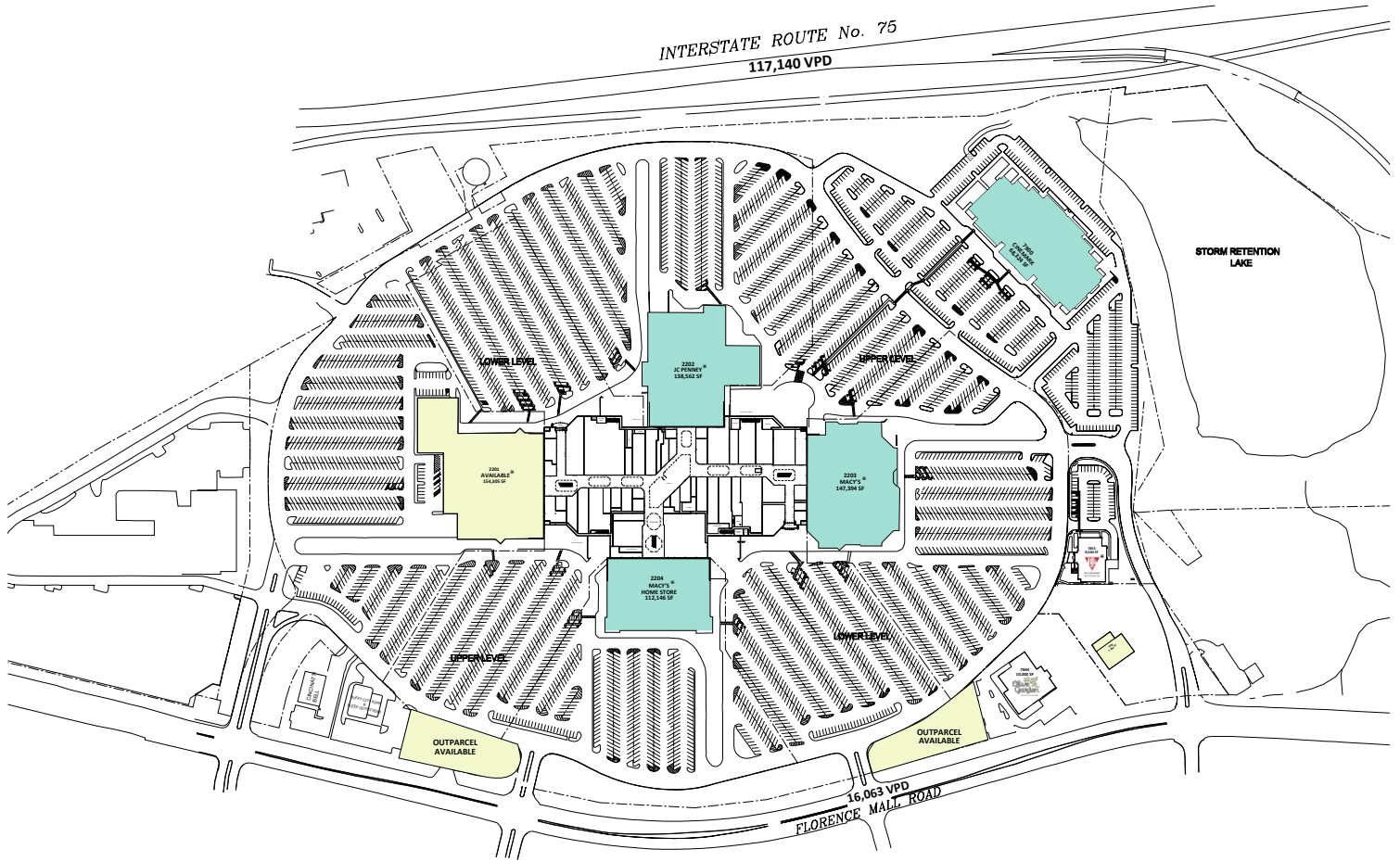

*NOT OWNED

LEASED AVAILABLE



MASON
ASSET MANAGEMENT

T: 516 371.5858
E: leasing@masonam.com
150 Great Neck Road Suite 402
Great Neck, NY, 11021
www.masonam.com

FLORENCE MALL

2080 Florence Mall, Florence KY 41042

LEASE PLAN LOWER LEVEL

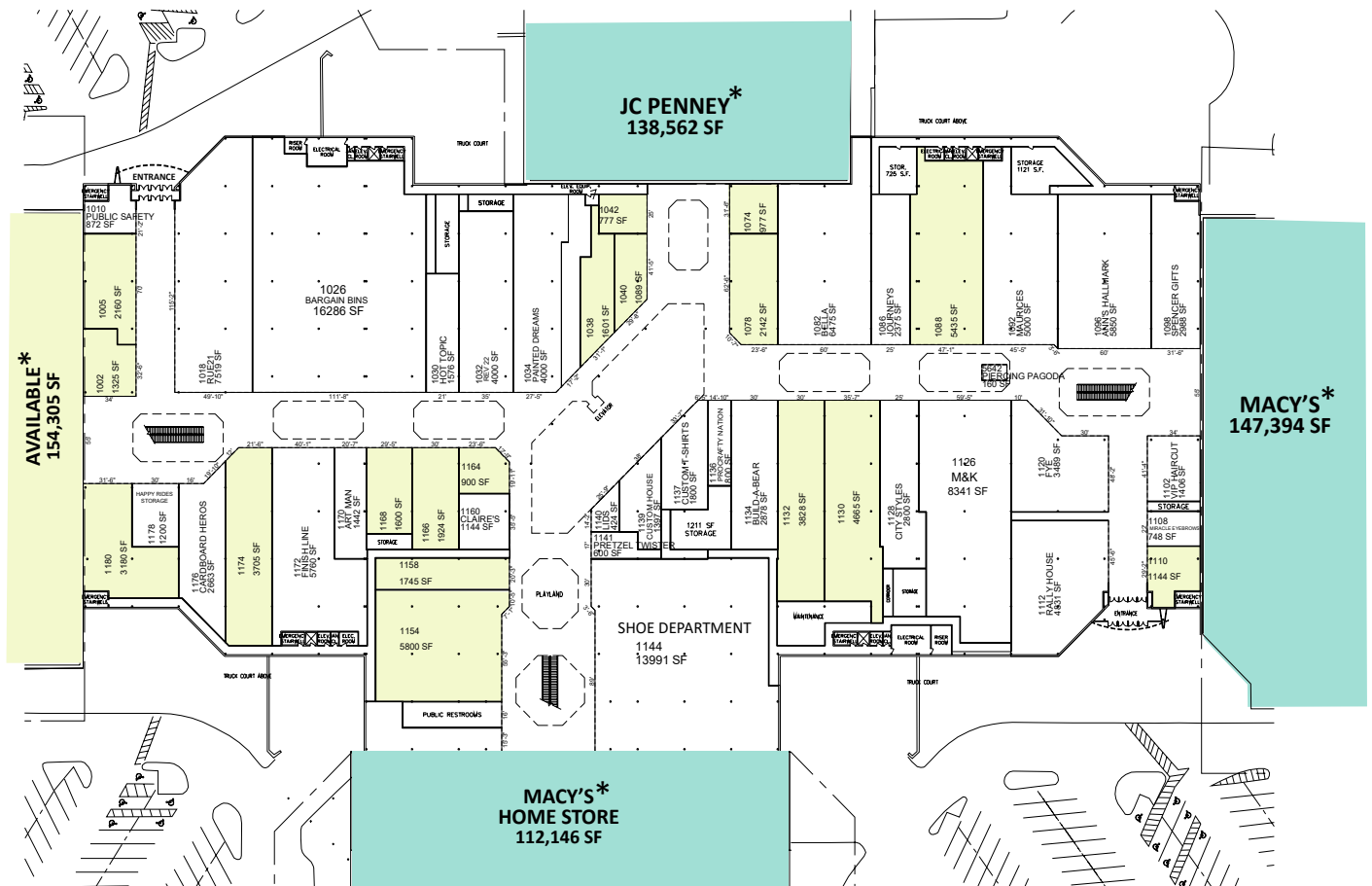

*NOT OWNED

LEASED AVAILABLE



MASON
ASSET MANAGEMENT

T: 516 371.5858
E: leasing@masonam.com
150 Great Neck Road Suite 402
Great Neck, NY, 11021
www.masonam.com

FLORENCE MALL

2028 Florence Mall, Florence KY 41042

LEASE PLAN UPPER LEVEL

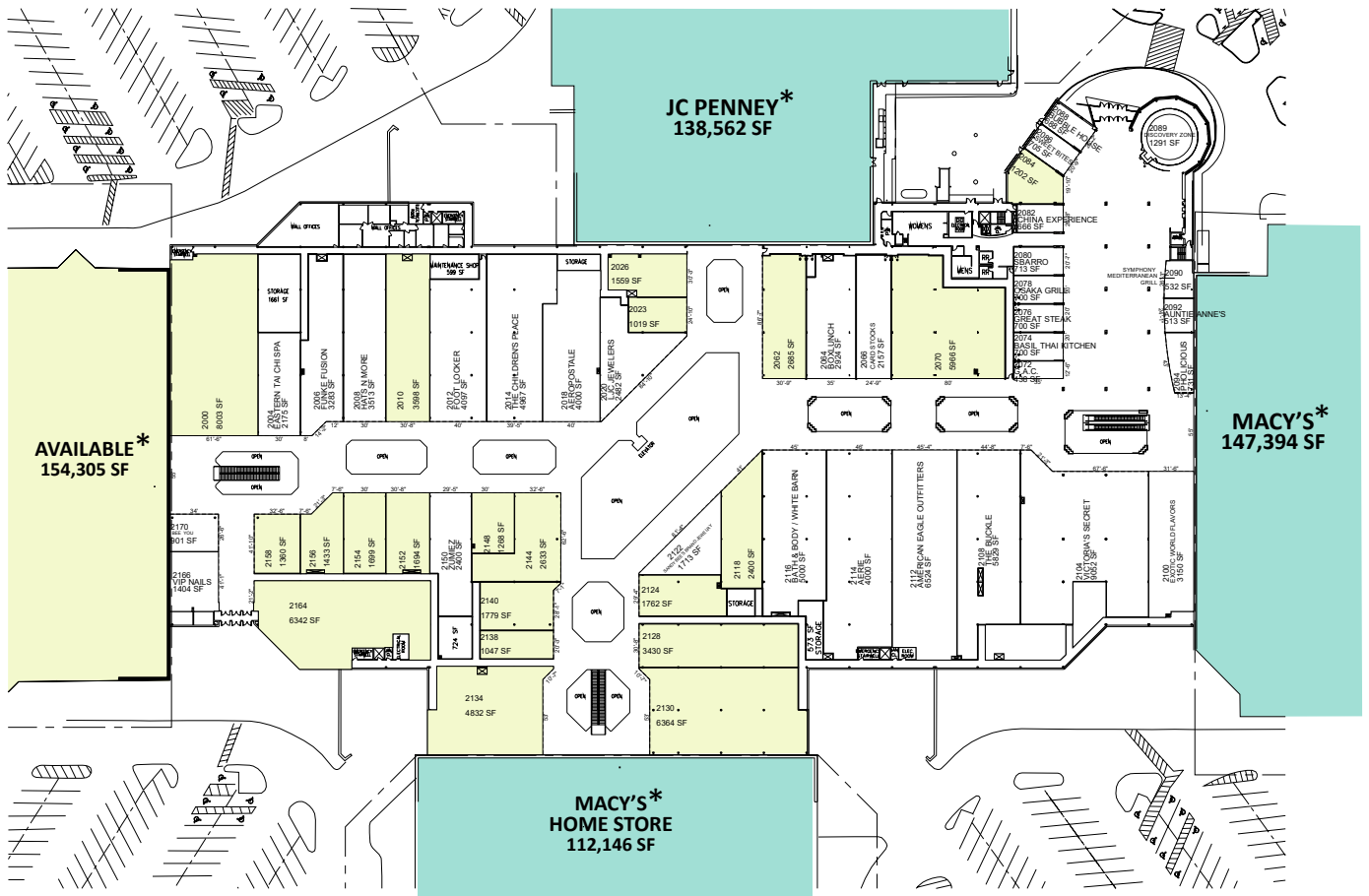

*NOT OWNED

LEASED
 AVAILABLE

FLORENCE MALL

2028 Florence Mall, Florence KY 41042

RETAILER MAP

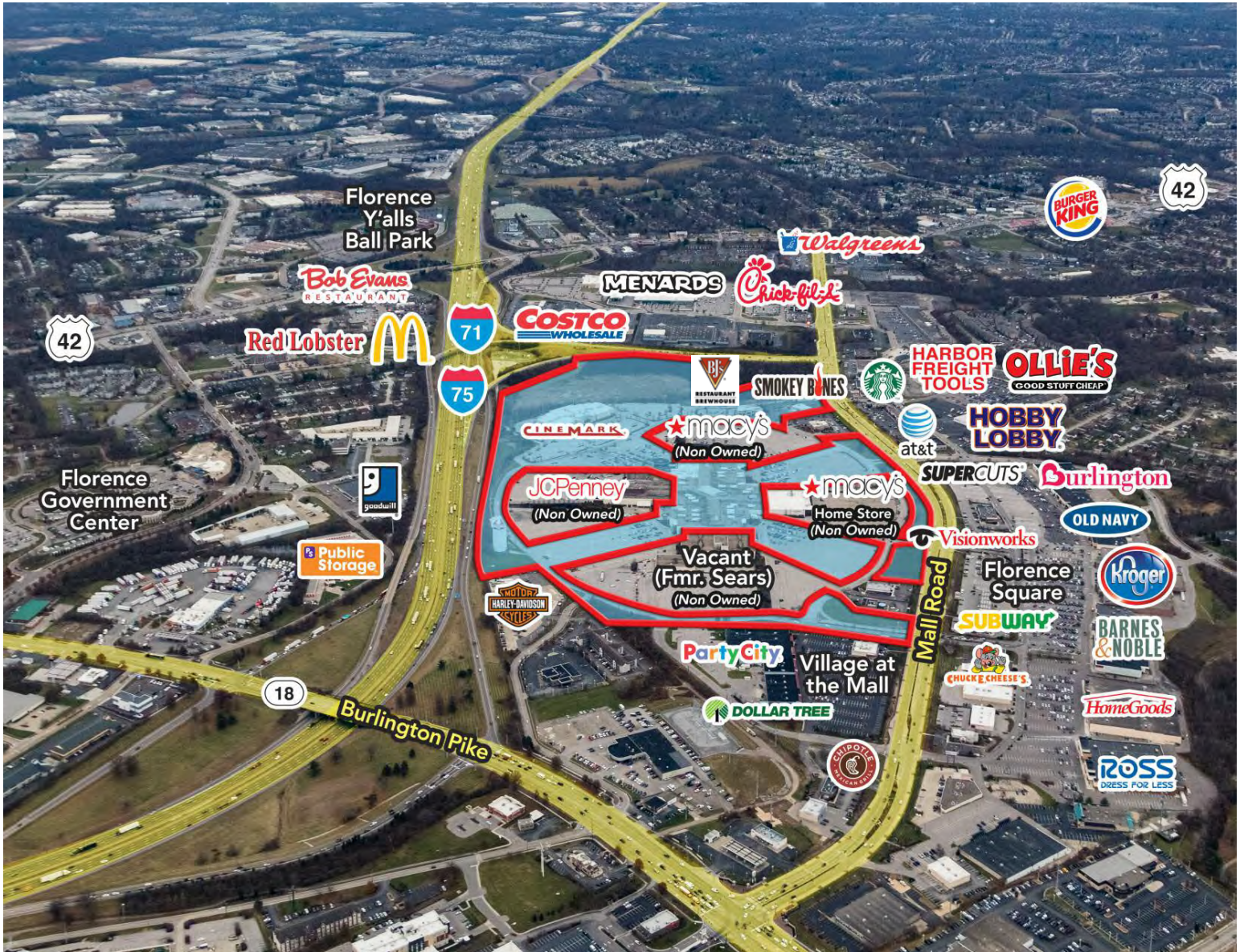

MASON
ASSET MANAGEMENT

T: 516 371.5858
E: leasing@masonam.com
150 Great Neck Road Suite 402
Great Neck, NY, 11021
www.masonam.com

FLORENCE MALL

2028 Florence Mall, Florence KY 41042

RADIUS MAP

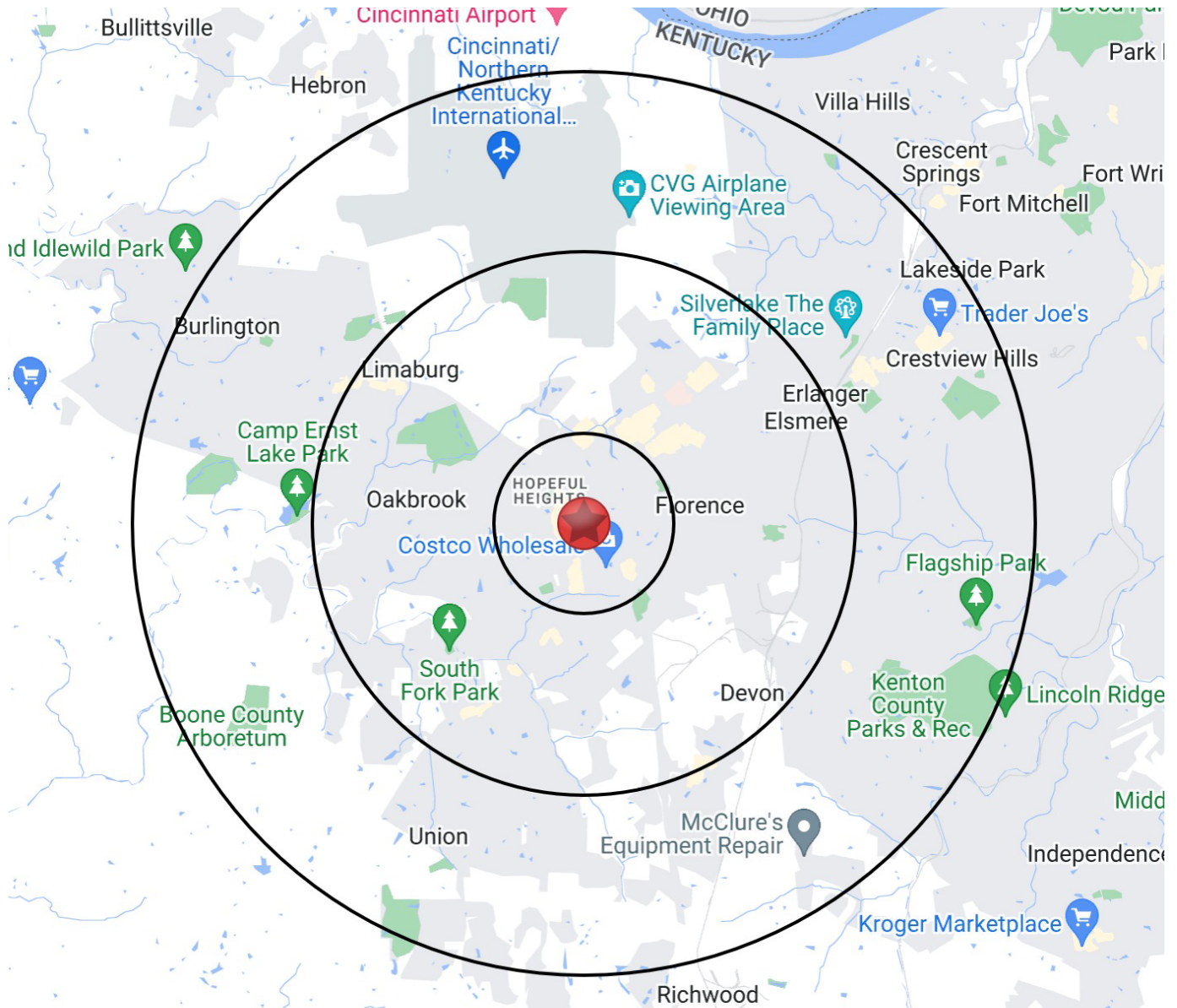

MASON
ASSET MANAGEMENT

T: 516 371.5858
E: leasing@masonam.com
150 Great Neck Road Suite 402
Great Neck, NY, 11021
www.masonam.com