

TUTTLE CROSSING MALL

5043 Tuttle Crossing Blvd, Dublin, OH 43016

PROPERTY

HIGHLIGHTS

Demographics	1 mile	3 miles	5 miles
Population	11,297	86,397	216,155
Avg. HH Income	\$127,498	\$133,035	\$143,966
Total Households	5,655	37,549	90,116

- Located in Dublin, OH and benefits from a densely populated trade area with more than 1.2 million residents within a 15-mile radius
- Highly visible, prominent location at the intersection of I-270 and Tuttle Crossing Blvd (~29,000 VPD) with significant frontage along I-270
- The heavily traveled beltway loop freeway in the Columbus metropolitan area with traffic counts in excess of 110,000 VPD – providing a high-traffic location with exceptional access from throughout the trade area.

NOTES

ANCHORS

- GLA: 1,121,518
- Availabilities: Anchor, Inline & Outparcel
- Traffic Count: 29,000 VPD Tuttle Crossing Blvd

- JC Penney, Macy's & Scene 75



MASON
ASSET MANAGEMENT

T: 516 371.5858
E: leasing@masonam.com
150 Great Neck Road Suite 402
Great Neck, NY, 11021
www.masonam.com

TUTTLE CROSSING MALL

5043 Tuttle Crossing Blvd, Dublin, OH 43016

LEASE PLAN LOWER LEVEL

LOWER LEVEL



*NOT OWNED

Leased Available



MASON
ASSET MANAGEMENT

T: 516 371.5858
E: leasing@masonam.com
150 Great Neck Road Suite 402
Great Neck, NY, 11021
www.masonam.com

TUTTLE CROSSING MALL

5043 Tuttle Crossing Blvd, Dublin, OH 43016

LEASE PLAN UPPER LEVEL

UPPER LEVEL

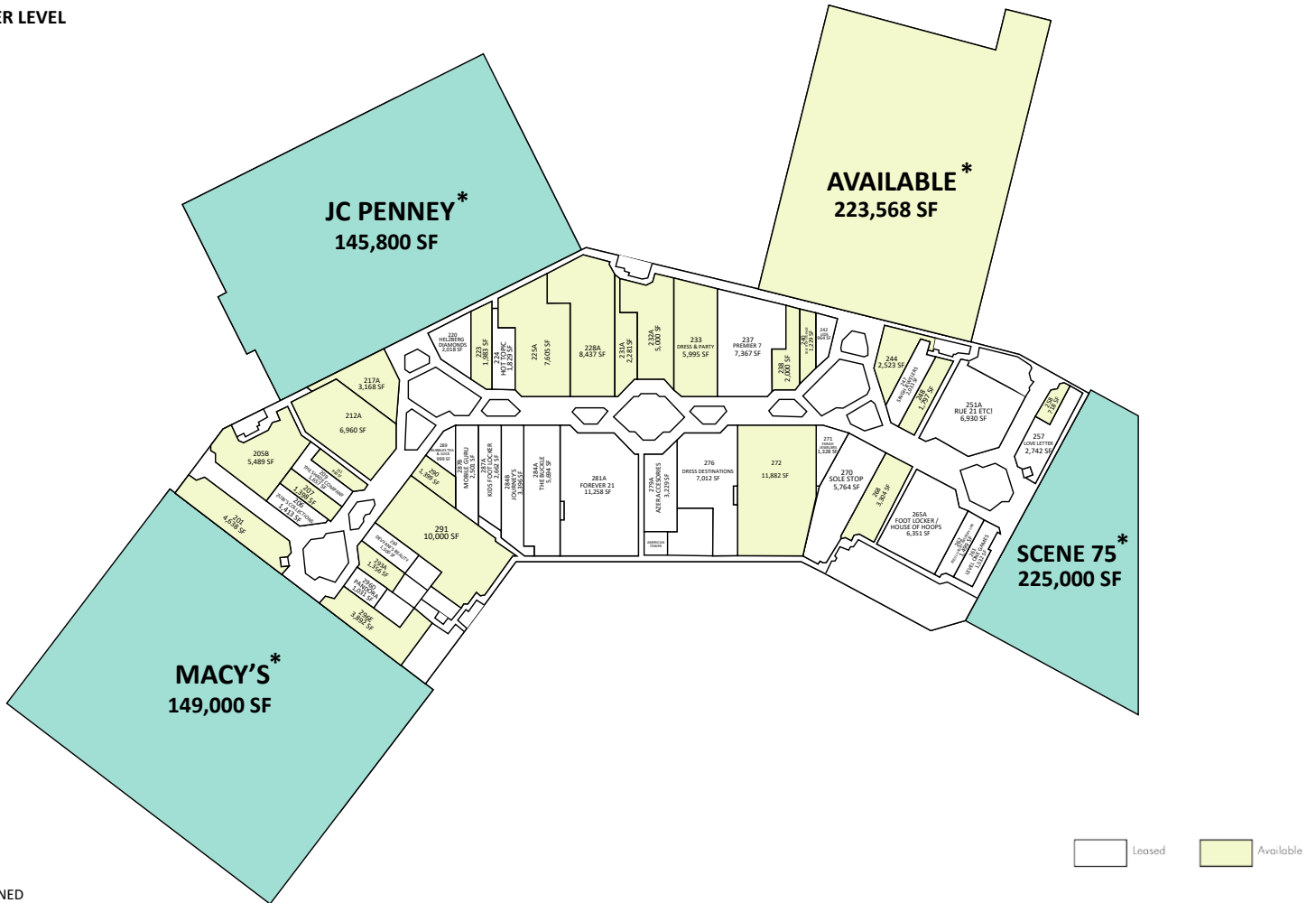

*NOT OWNED



MASON
ASSET MANAGEMENT

T: 516 371.5858
E: leasing@masonam.com
150 Great Neck Road Suite 402
Great Neck, NY, 11021
www.masonam.com

TUTTLE CROSSING MALL

5043 Tuttle Crossing Blvd, Dublin, OH 43016

SITE PLAN



Leased Available

*NOT OWNED



MASON
ASSET MANAGEMENT

T: 516 371.5858
E: leasing@masonam.com
150 Great Neck Road Suite 402
Great Neck, NY, 11021
www.masonam.com

TUTTLE CROSSING MALL

5043 Tuttle Crossing Blvd, Dublin, OH 43016

RADIUS MAP

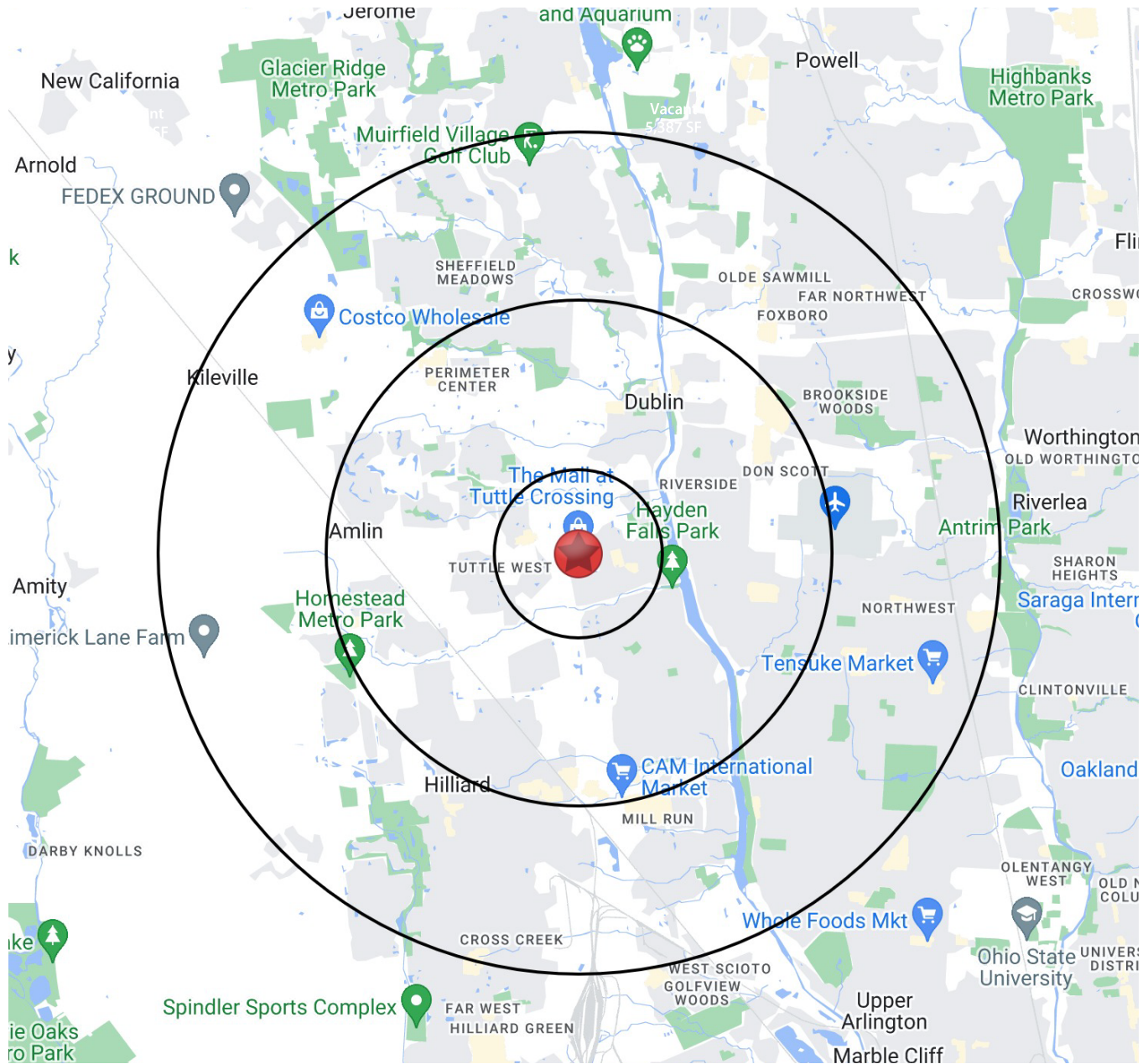

MASON
ASSET MANAGEMENT

T: 516 371.5858
E: leasing@masonam.com
150 Great Neck Road Suite 402
Great Neck, NY, 11021
www.masonam.com