

THE BOLD

27-01 JACKSON AVE

LONG ISLAND CITY, NY 11101

LOCATION

Long Island City, Queens, NY
NEC Jackson Ave. & 43rd Ave.
(between 43rd Ave & Ed Koch Bridge)

SIZE

5,076 SF 2nd floor
2,526 SF Ground Floor

Demographics	0.25 mile	0.5 miles	1 miles
Population	18,438	34,080	84,911
Avg. HH Income	\$106,805	\$96,645	\$113,387
Total Households	6,289	13,024	34,997

HIGHLIGHTS

The Bold is a 27-story mixed-use building in the Court Square neighborhood of Long Island City. The Bold will bring 164 new rental residences. Approximately 7,600 SF of retail available on the ground and second floor. Walking distance from One Court Square Subway station. Area Tenants include Target and other national and regional brands.



THE BOLD 27-01 JACKSON AVE LONG ISLAND CITY, NY 11101

TRANSPORTATION | RETAIL

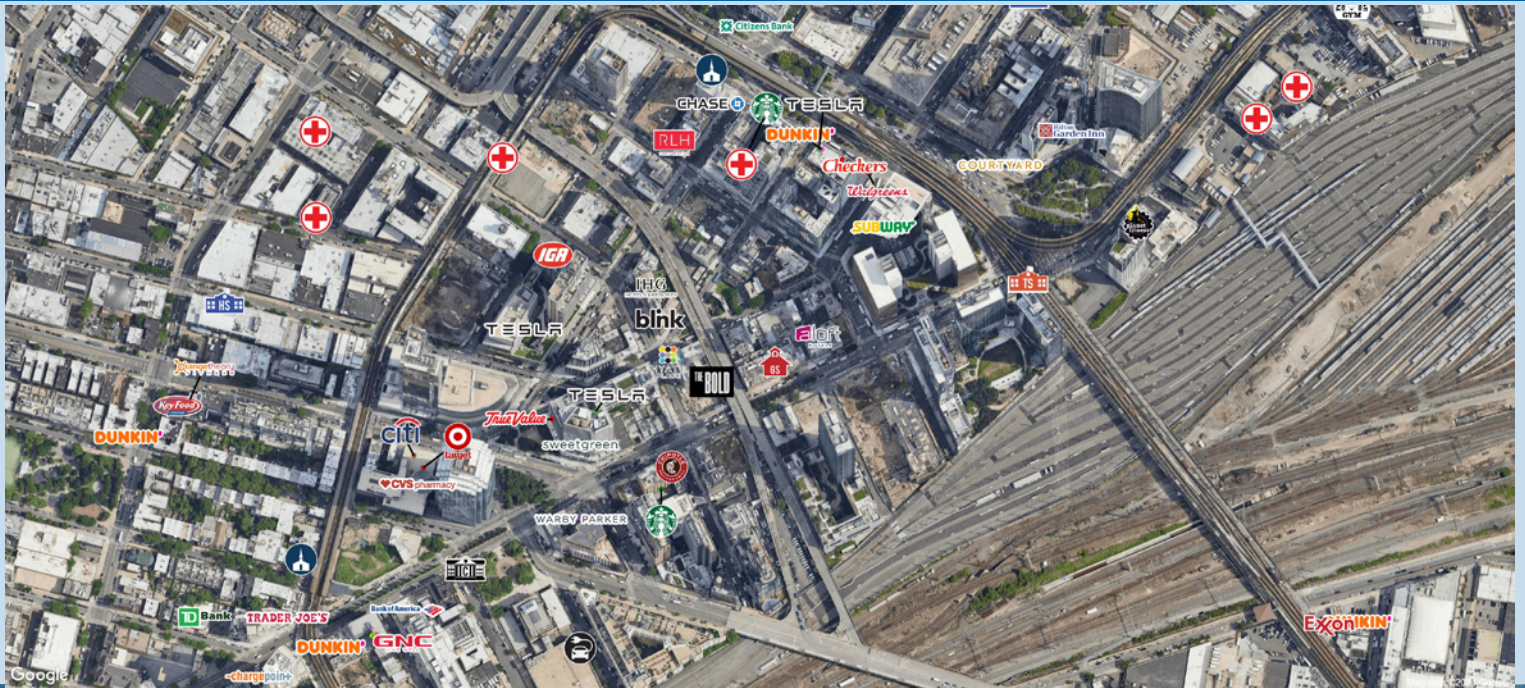
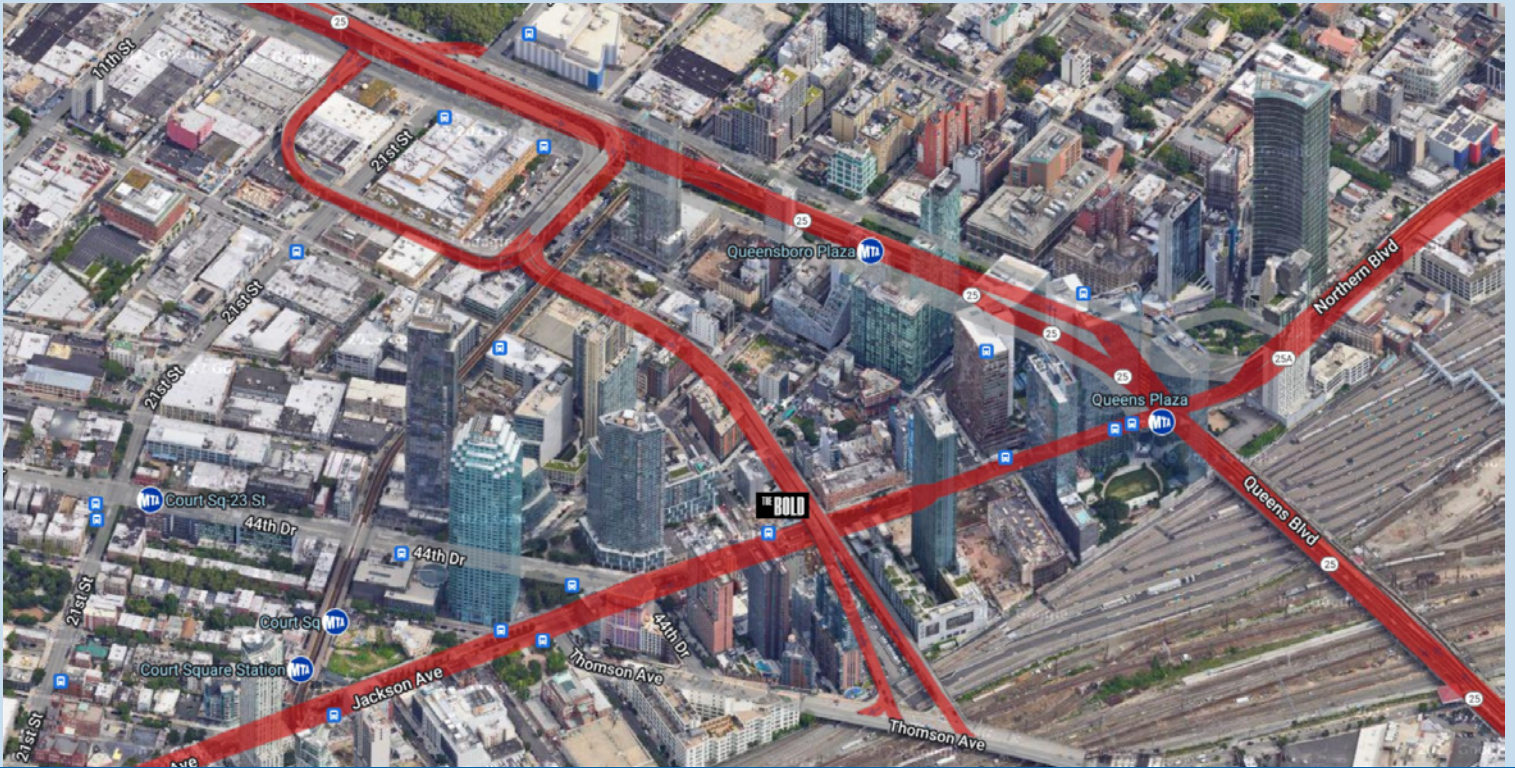

T: 516 371.5858

E: leasing@masonam.com

150 Great Neck Road Suite 402

Great Neck, NY, 11024

www.masonam.com



MASON
ASSET MANAGEMENT

SITE PLAN GROUND FLOOR

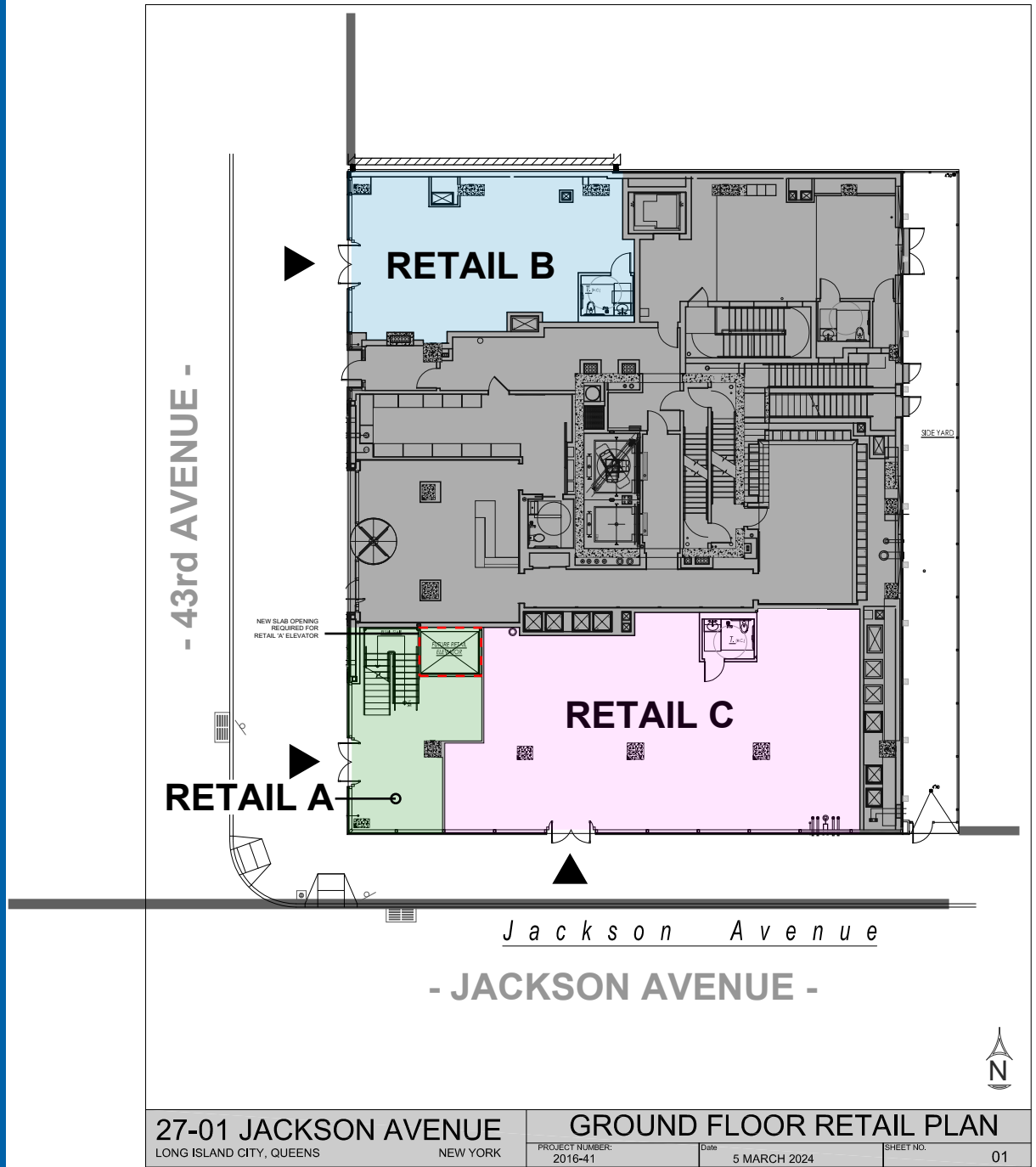

SITE PLAN SECOND FLOOR

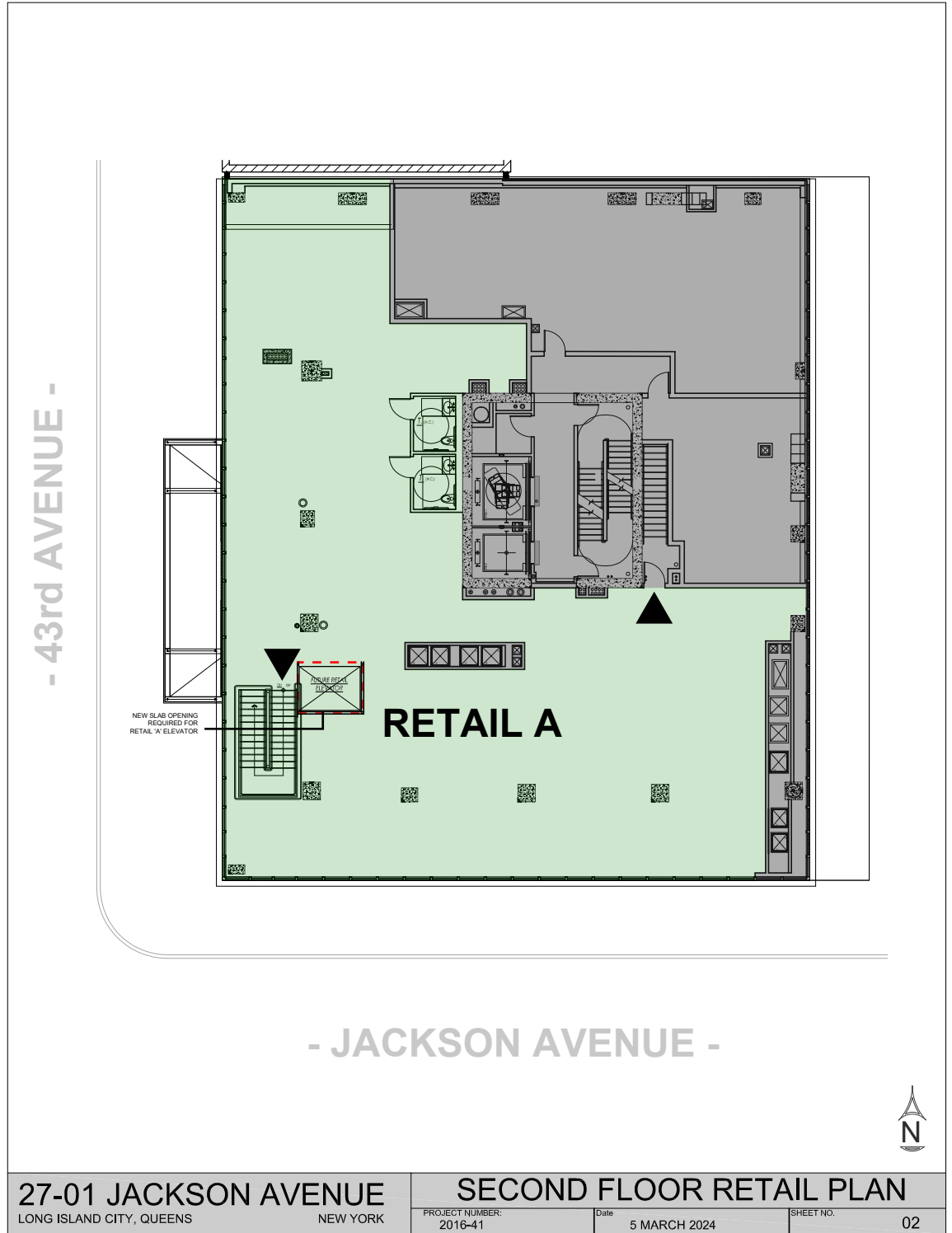

MASON
ASSET MANAGEMENT

T: 516 371.5858
E: leasing@masonam.com

150 Great Neck Road Suite 402
Great Neck, NY, 11024
www.masonam.com