

NW ARKANSAS MALL

4201 N. Shiloh Drive, Fayetteville, AR 72703

PROPERTY

HIGHLIGHTS

Demographics	1 mile	3 miles	5 miles
Population	6,270	46,910	142,277
Avg. HH Income	\$76,277	\$98,843	\$94,956
Total Households	3,116	19,535	54,273

- Located on North College Ave.
- Rated top 5 city to live by U.S. News & World Report
- 5 miles North of The University of Arkansas
- 26,000+ college students within 5 miles

NOTES

ANCHORS

- GLA: 820,645 SF
- Traffic Count: US HWY 71 B 32,885 VPD

- JC Penney, Dillard's & Crunch Fitness



MASON
ASSET MANAGEMENT

T: 516 371.5858
E: leasing@masonam.com
150 Great Neck Road Suite 402
Great Neck, NY, 11021
www.masonam.com

NW ARKANSAS MALL

4201 N. Shiloh Drive, Fayetteville, AR 72703

LEASE PLAN

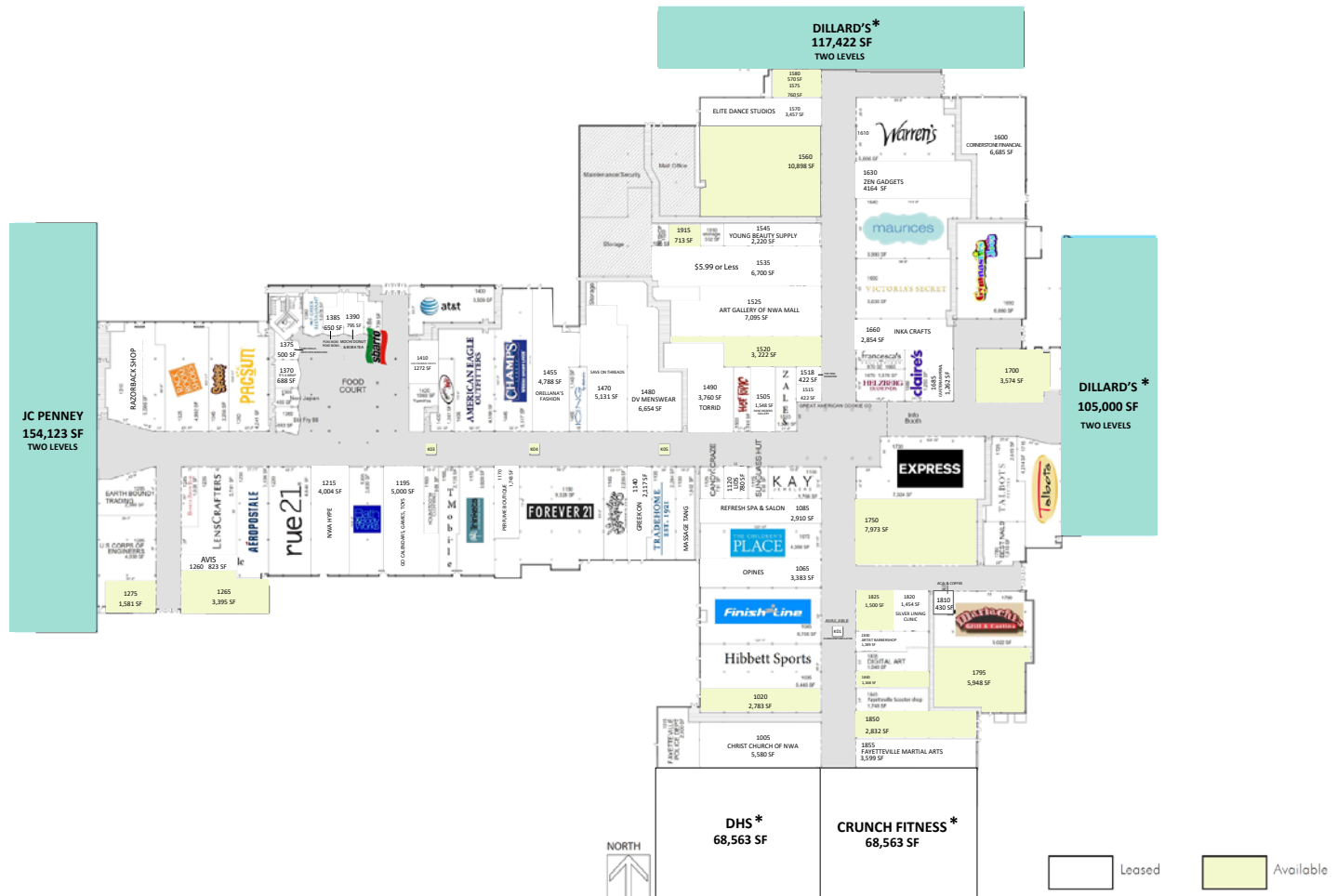

*NOT OWNED



MASON
ASSET MANAGEMENT

T: 516 371.5858
E: leasing@masonam.com
150 Great Neck Road Suite 402
Great Neck, NY, 11021
www.masonam.com

NW ARKANSAS MALL

4201 N. Shiloh Drive, Fayetteville, AR 72703

SITE PLAN

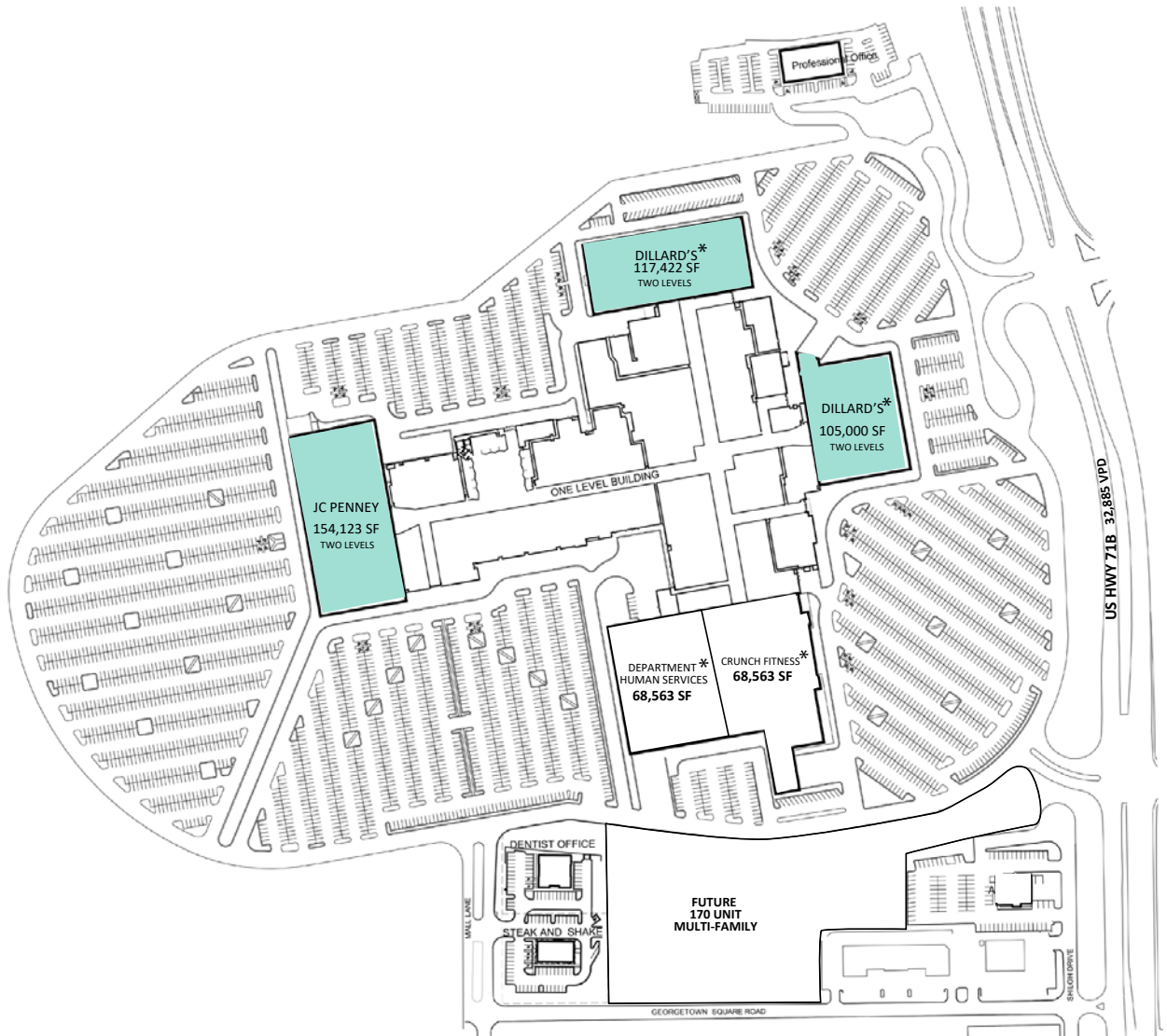

*NOT OWNED



MASON
ASSET MANAGEMENT

T: 516 371.5858
E: leasing@masonam.com
150 Great Neck Road Suite 402
Great Neck, NY, 11021
www.masonam.com

NW ARKANSAS MALL

4201 N. Shiloh Drive, Fayetteville, AR 72703

RADIUS MAP

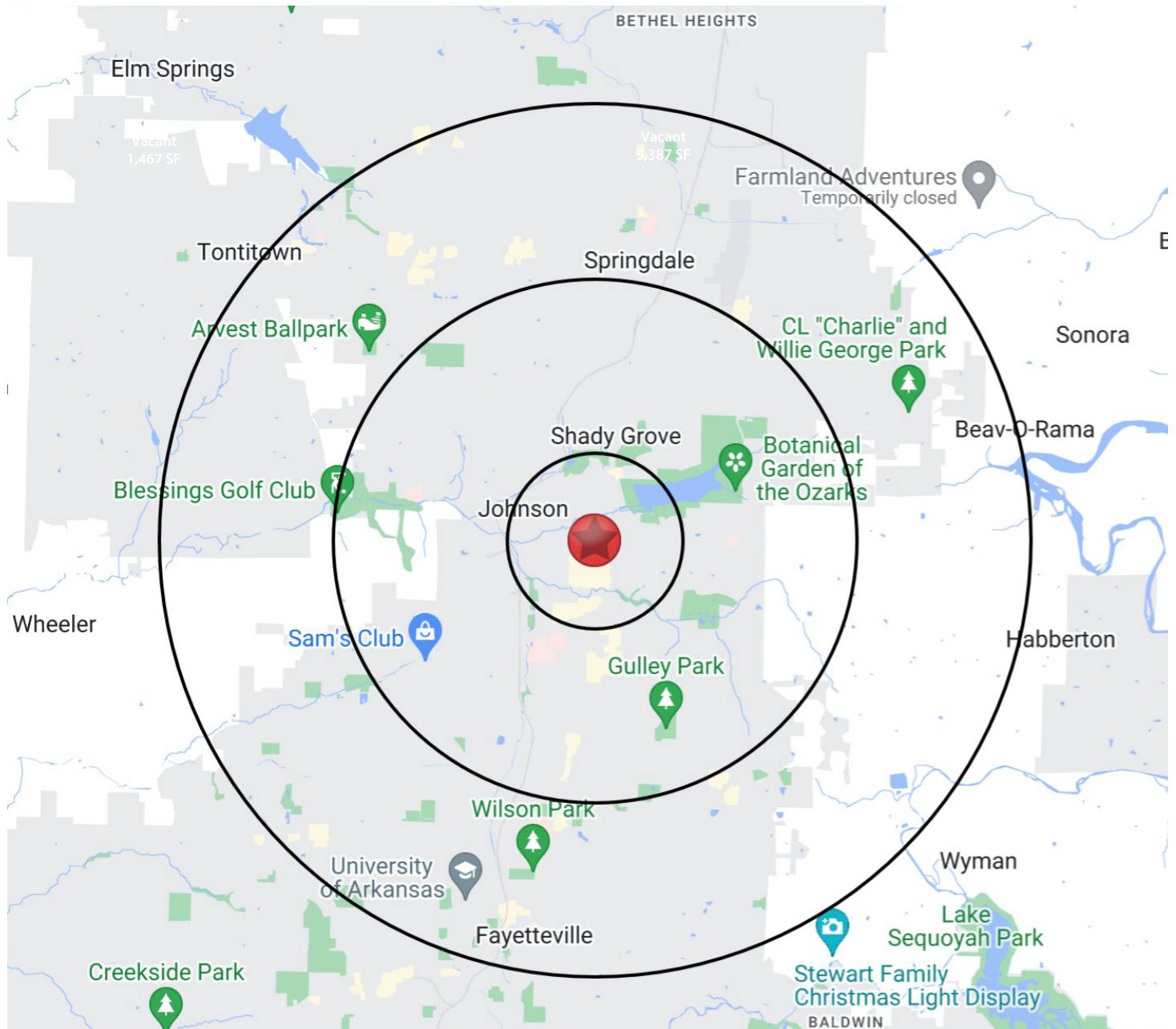

MASON
ASSET MANAGEMENT

T: 516 371.5858
E: leasing@masonam.com
150 Great Neck Road Suite 402
Great Neck, NY, 11021
www.masonam.com